

TV241L TRADITIONAL LEATHER VISITORS CHAIR

OPERATING INSTRUCTIONS



WARNING

1. Use this product only one person at a time.
2. Do not use this chair unless all bolts, screws and knobs are securely tightened.
3. Check that all bolts screws and knobs are tight every three months or as needed.
4. Dispose of packing material properly. Do not use plastic cover as head covering. It may cause suffocation.
5. Do not use chair as a stepladder.
6. Use this chair for its intended purpose only.
7. Use mild detergent only for cleaning.

WARRANTY

Work Smart chairs are warranted from the date of purchase against failure due to material and workmanship as follows:

- 15 Years on all non-moving metal parts.
- 5 Years on component parts including Control mechanisms, pneumatic cylinders, wood, plastic parts, base and casters.
- 3 Years on upholstery fabric and foam against wear and deterioration.
- We cannot warrant leather against routine scratching and scuffing, as all leather is subject to minor blemishes in use.

To make a warranty claim, contact Parts Department. Provide model number, proof of purchase, description of the problem and obtain return authorization. At it's option Office Star Products will:

- (a) Supply compatible components of current manufacture.
- (b) Repair the customer's component. The customer must prepay freight on any components returned to the factory. Return freight on components still in warranty will be paid by Office Star Products.

**All warranties are limited to the original purchaser for normal commercial usage defined as a standard forty hour work week by persons weighing 250 lbs. or less. This warranty will not cover labor, freight or damage from misuse, abuse, negligence, alteration, accident, vandalism, rusting, acts of nature or any other event beyond the control of Office Star Products. The warranty does not cover cosmetic damage that may result from normal use. Liability for incidental or consequential damages is excluded. The user assumes all risk of injury resulting from use of this product. When usage is more than 40 hours per week, a two year warranty on all parts applies. Fabric and foam is warranted for one year.*

This warranty gives you specific legal rights, and you may also have other rights which vary from state to state.

All Work Smart chairs are built to meet or exceed ANSI BIFMA standards.

Our quality standards are among the highest in the industry. Sometimes, no matter how hard we try, there are times when parts are damaged or missing. Our Parts Department will do everything possible to promptly remedy the problem. Contact us via e-mail parts@officestar.net, by Fax 1-909-930-5629, or toll free parts number 1-800-950-7262, Monday through Friday 8:00 a.m. - 5:00 p.m. Pacific Time.



TV241L TRADITIONAL LEATHER VISITORS CHAIR

ASSEMBLY INSTRUCTIONS

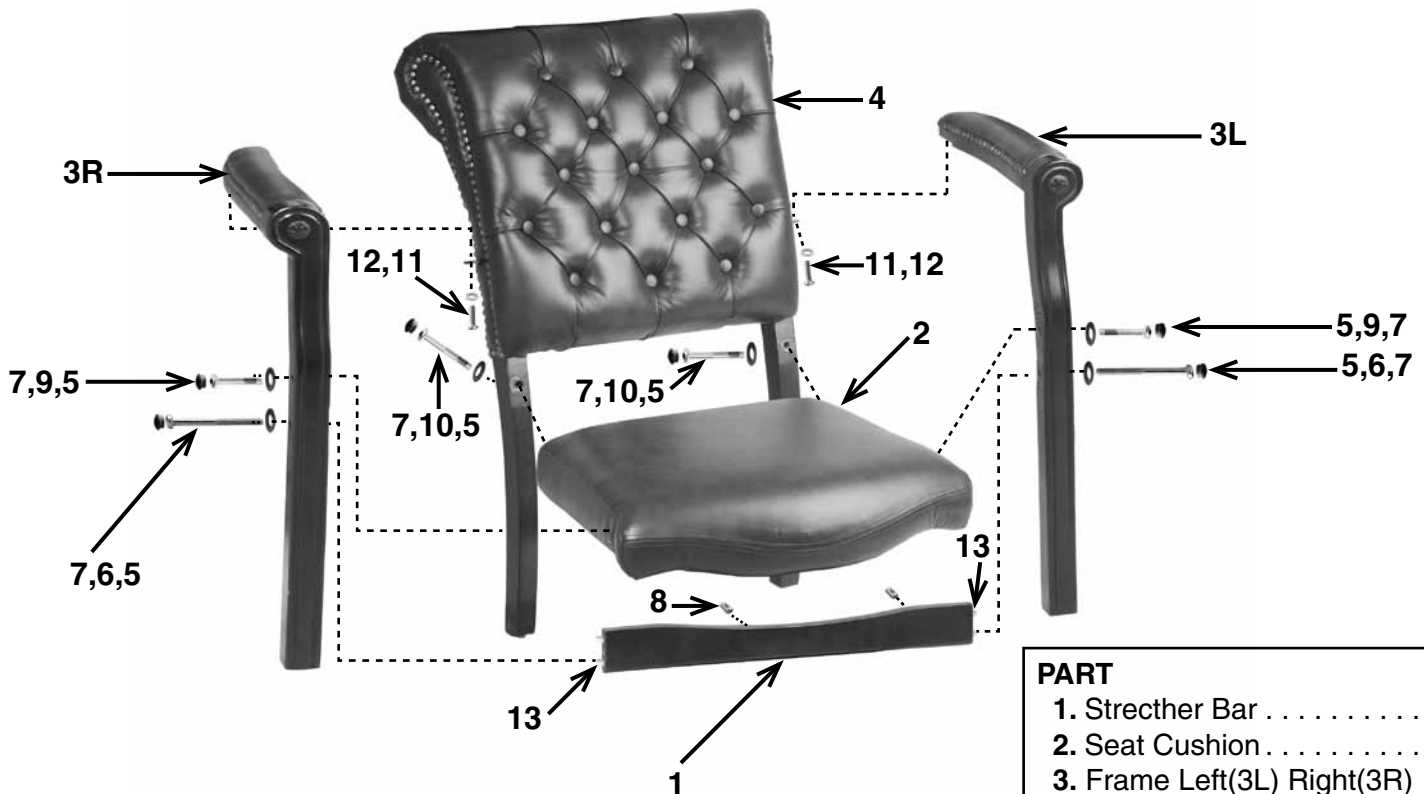

PART	QTY
1. Stretcher Bar	1
2. Seat Cushion	1
3. Frame Left(3L) Right(3R)	2
4. Backrest Assembly	1
5. Small Washer	6
6. 2 ³ / ₄ " Length Screw	2
7. Wooden Plug	6
8. Barrel Nut	2
9. 1 1/2" Length Screw	2
10. 2 3/16" Length Screw	2
11. Large Washer	2
12. 1 1/4" Length Screw	2
13. Wood Dowel	4
14. Allen Wrench (Not Shown)	1

DETAIL A

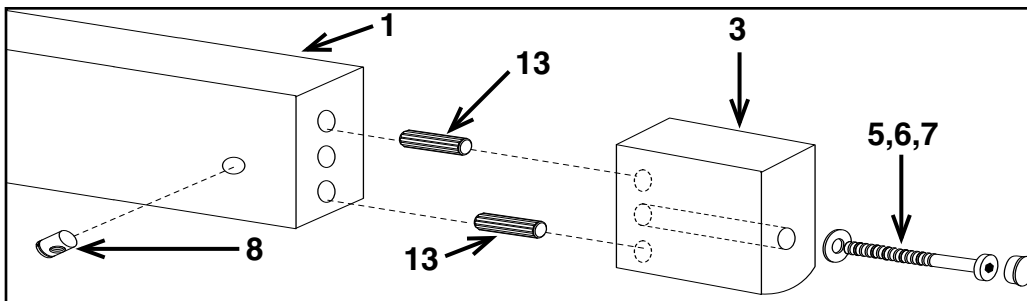

Remove all parts from carton, separate by part numbers indicated on parts list, and verify part quantities.

STEP 1 Attach Backrest Assembly (4) to Seat Cushion (2) using two 2 ³/₁₆" Length Screws (10) and two Small Washers (5).

STEP 2 Insert four Wood Dowels (13) into holes of Stretcher Bar (1) **AS SHOWN IN DETAIL A.**

STEP 3 Insert two Barrel Nuts (8) into the holes of Stretcher Bar (1). Attach Frame(3L and 3R) to Stretcher Bar (1) using two 2³/₄" Length Screws (6) and Small Washers (5) **AS SHOWN IN DETAIL A. DO NOT FULLY TIGHTEN SCREW.**

STEP 4 Align the upper holes of the Frame (3L and 3R) with the holes in the Seat Cushion (2). Attach the Frame(3L and 3R) to the Seat Cushion (2) using two 1 1/2" Length Screws (9) and two Small Washers (5).

STEP 5 Attach Frame (3L and 3R) to Backrest Assembly (4) using two 1 1/4" Length Screws (12) and two Large Washers (11).

STAND CHAIR UPRIGHT. FULLY TIGHTEN ALL SCREWS IN STRETCHER BAR (1) FIRST, THEN FULLY TIGHTEN ALL OTHER SCREWS.

STEP 6 Cover holes on the Frame (3) and Backrest Assembly (4) with six Wooden Plugs (7).

ATTENTION: MAKE SURE ALL SCREWS ARE FULLY TIGHTENED BEFORE USING CHAIR.